

LED FLOODLIGHT

LLF0112A Narrow type Installation Instructions

For retention

● This product must be installed in accordance with applicable national and local electrical and construction codes by a qualified electrician. Installation by a unqualified person is prohibited by law.

Name	1/2 Beam Angle	Light Color	Power Consumption	Weight	Construction Size	Projected Area	Housing Color
LLF0112A/MWWD01722XVNSBK(WH/SI)SCCE1	2.5°	2200K	16.9W	3.1kg	183x295 x113 (Unit:mm)	0.046m ²	BK:Charcoal gray (WH : White SI : Silver)
LLF0112A/MWWD01722X03SBK(WH/SI)SCCE1	3°						
LLF0112A/MWWD01722X04SBK(WH/SI)SCCE1	4°						
LLF0112A/MWWD01722X05SBK(WH/SI)SCCE1	5°						
LLF0112A/MWWD01722X06SBK(WH/SI)SCCE1	6°						
LLF0112A/MWWD01722X07SBK(WH/SI)SCCE1	7°						
LLF0112A/MWWD01722X08SBK(WH/SI)SCCE1	8°						
LLF0112A/MWWD01722X09SBK(WH/SI)SCCE1	9°						
LLF0112A/MWWD01727XVNSBK(WH/SI)SCCE1	2.5°	2700K	16.9W	3.1kg	183x295 x113 (Unit:mm)	0.046m ²	BK:Charcoal gray (WH : White SI : Silver)
LLF0112A/MWWD01727X03SBK(WH/SI)SCCE1	3°						
LLF0112A/MWWD01727X04SBK(WH/SI)SCCE1	4°						
LLF0112A/MWWD01727X05SBK(WH/SI)SCCE1	5°						
LLF0112A/MWWD01727X06SBK(WH/SI)SCCE1	6°						
LLF0112A/MWWD01727X07SBK(WH/SI)SCCE1	7°						
LLF0112A/MWWD01727X08SBK(WH/SI)SCCE1	8°						
LLF0112A/MWWD01727X09SBK(WH/SI)SCCE1	9°						
LLF0112A/MWWD01730XVNSBK(WH/SI)SCCE1	2.5°	3000K	16.9W	3.1kg	183x295 x113 (Unit:mm)	0.046m ²	BK:Charcoal gray (WH : White SI : Silver)
LLF0112A/MWWD01730X03SBK(WH/SI)SCCE1	3°						
LLF0112A/MWWD01730X04SBK(WH/SI)SCCE1	4°						
LLF0112A/MWWD01730X05SBK(WH/SI)SCCE1	5°						
LLF0112A/MWWD01730X06SBK(WH/SI)SCCE1	6°						
LLF0112A/MWWD01730X07SBK(WH/SI)SCCE1	7°						
LLF0112A/MWWD01730X08SBK(WH/SI)SCCE1	8°						
LLF0112A/MWWD01730X09SBK(WH/SI)SCCE1	9°						
LLF0112A/MWWD01740XVNSBK(WH/SI)SCCE1	2.5°	4000K	16.9W	3.1kg	183x295 x113 (Unit:mm)	0.046m ²	BK:Charcoal gray (WH : White SI : Silver)
LLF0112A/MWWD01740X03SBK(WH/SI)SCCE1	3°						
LLF0112A/MWWD01740X04SBK(WH/SI)SCCE1	4°						
LLF0112A/MWWD01740X05SBK(WH/SI)SCCE1	5°						
LLF0112A/MWWD01740X06SBK(WH/SI)SCCE1	6°						
LLF0112A/MWWD01740X07SBK(WH/SI)SCCE1	7°						
LLF0112A/MWWD01740X08SBK(WH/SI)SCCE1	8°						
LLF0112A/MWWD01740X09SBK(WH/SI)SCCE1	9°						

Name	1/2 Beam Angle	Light Color	Power Consumption	Weight	Construction Size	Projected Area	Housing Color
LLF0112A/MWWD01750XVNSBK(WH/SI)SCCE1	2.5°	5000K	16.9W	3.1kg	183x295 x113 (Unit:mm)	0.046m ²	BK:Charcoal gray (WH : White SI : Silver)
LLF0112A/MWWD01750X03SBK(WH/SI)SCCE1	3°						
LLF0112A/MWWD01750X04SBK(WH/SI)SCCE1	4°						
LLF0112A/MWWD01750X05SBK(WH/SI)SCCE1	5°						
LLF0112A/MWWD01750X06SBK(WH/SI)SCCE1	6°						
LLF0112A/MWWD01750X07SBK(WH/SI)SCCE1	7°						
LLF0112A/MWWD01750X08SBK(WH/SI)SCCE1	8°						
LLF0112A/MWWD01750X09SBK(WH/SI)SCCE1	9°						
LLF0112A/MWWD01757XVNSBK(WH/SI)SCCE1	2.5°	5700K	16.9W	3.1kg	183x295 x113 (Unit:mm)	0.046m ²	BK:Charcoal gray (WH : White SI : Silver)
LLF0112A/MWWD01757X03SBK(WH/SI)SCCE1	3°						
LLF0112A/MWWD01757X04SBK(WH/SI)SCCE1	4°						
LLF0112A/MWWD01757X05SBK(WH/SI)SCCE1	5°						
LLF0112A/MWWD01757X06SBK(WH/SI)SCCE1	6°						
LLF0112A/MWWD01757X07SBK(WH/SI)SCCE1	7°						
LLF0112A/MWWD01757X08SBK(WH/SI)SCCE1	8°						
LLF0112A/MWWD01757X09SBK(WH/SI)SCCE1	9°						
LLF0112A/MWWD01765XVNSBK(WH/SI)SCCE1	2.5°	6500K	16.9W	3.1kg	183x295 x113 (Unit:mm)	0.046m ²	BK:Charcoal gray (WH : White SI : Silver)
LLF0112A/MWWD01765X03SBK(WH/SI)SCCE1	3°						
LLF0112A/MWWD01765X04SBK(WH/SI)SCCE1	4°						
LLF0112A/MWWD01765X05SBK(WH/SI)SCCE1	5°						
LLF0112A/MWWD01765X06SBK(WH/SI)SCCE1	6°						
LLF0112A/MWWD01765X07SBK(WH/SI)SCCE1	7°						
LLF0112A/MWWD01765X08SBK(WH/SI)SCCE1	8°						
LLF0112A/MWWD01765X09SBK(WH/SI)SCCE1	9°						
LLF0112A/MWWD017REDVNSBK(WH/SI)SCCE1	2.5°	RED	13.2W	3.1kg	183x295 x113 (Unit:mm)	0.046m ²	BK:Charcoal gray (WH : White SI : Silver)
LLF0112A/MWWD017RED03SBK(WH/SI)SCCE1	3°						
LLF0112A/MWWD017RED04SBK(WH/SI)SCCE1	4°						
LLF0112A/MWWD017RED05SBK(WH/SI)SCCE1	5°						
LLF0112A/MWWD017RED06SBK(WH/SI)SCCE1	6°						
LLF0112A/MWWD017RED07SBK(WH/SI)SCCE1	7°						
LLF0112A/MWWD017RED08SBK(WH/SI)SCCE1	8°						
LLF0112A/MWWD017RED09SBK(WH/SI)SCCE1	9°						
LLF0112A/MWWD017GREVNSBK(WH/SI)SCCE1	2.5°	GREEN	15.6W	3.1kg	183x295 x113 (Unit:mm)	0.046m ²	BK:Charcoal gray (WH : White SI : Silver)
LLF0112A/MWWD017GRE03SBK(WH/SI)SCCE1	3°						
LLF0112A/MWWD017GRE04SBK(WH/SI)SCCE1	4°						
LLF0112A/MWWD017GRE05SBK(WH/SI)SCCE1	5°						
LLF0112A/MWWD017GRE06SBK(WH/SI)SCCE1	6°						
LLF0112A/MWWD017GRE07SBK(WH/SI)SCCE1	7°						
LLF0112A/MWWD017GRE08SBK(WH/SI)SCCE1	8°						
LLF0112A/MWWD017GRE09SBK(WH/SI)SCCE1	9°						

Name	1/2 Beam Angle	Light Color	Power Consumption	Weight	Construction Size	Projected Area	Housing Color
LLF0112A/MWWD017BLUVNSBK(WH/SI)SCCE1	2.5°	BLUE	16.9W	3.1kg	183x295 x113 (Unit:mm)	0.046m²	BK:Charcoal gray (WH : White SI : Silver)
LLF0112A/MWWD017BLU03SBK(WH/SI)SCCE1	3°						
LLF0112A/MWWD017BLU04SBK(WH/SI)SCCE1	4°						
LLF0112A/MWWD017BLU05SBK(WH/SI)SCCE1	5°						
LLF0112A/MWWD017BLU06SBK(WH/SI)SCCE1	6°						
LLF0112A/MWWD017BLU07SBK(WH/SI)SCCE1	7°						
LLF0112A/MWWD017BLU08SBK(WH/SI)SCCE1	8°						
LLF0112A/MWWD017BLU09SBK(WH/SI)SCCE1	9°						
LLF0112A/MWWD017YELVNSBK(WH/SI)SCCE1	2.5°	GOLD	16.9W	5.2kg	183x295 x113 (Unit:mm)	0.08m²	BK:Charcoal gray (WH : White SI : Silver)
LLF0112A/MWWD017YEL03SBK(WH/SI)SCCE1	3°						
LLF0112A/MWWD017YEL04SBK(WH/SI)SCCE1	4°						
LLF0112A/MWWD017YEL05SBK(WH/SI)SCCE1	5°						
LLF0112A/MWWD017YEL06SBK(WH/SI)SCCE1	6°						
LLF0112A/MWWD017YEL07SBK(WH/SI)SCCE1	7°						
LLF0112A/MWWD017YEL08SBK(WH/SI)SCCE1	8°						
LLF0112A/MWWD017YEL09SBK(WH/SI)SCCE1	9°						

●Accessories

Hood : LLF0112A/HOOD(0.38kg)
Louver : LLF0112A/LOUVER(0.41kg)

- This product is classified as Class Ⅲ luminaire.
- This product is heavy-duty salt resistant spec.
- The product is not protected against lightning surge.
Please purchase the optional SPD (Lightning Surge Protection Device) as necessary.

Construction	Leave the instructions for users/customers for future reference.
--------------	--

 WARNING	Failure to comply with the following installation instructions may result in death or serious injury.
<ul style="list-style-type: none">●This product must be installed in accordance with the installation instructions to avoid malfunction, fixture fall, electrical shock or fire.●This product is for general outdoor and indoor use only.●Do not use the product in the following environment or situation.<ul style="list-style-type: none">- Places where the humidity exceeds 90% RH or the product is covered with water.- Places where vibration or shock are transmitted to the fixture, e.g. where the crane is installed.- Places where fixtures are directly exposed to organic solvents (acetone, ethyl ether, hexane, etc.)- Places filled with corrosive gas (hydrogen sulfide, ammonia, etc.) and flammable gas (hydrogen, methane, propane, etc.)- Indoor pools where chlorine is used.- Places where flammable liquid (gasoline, kerosene, heavy oil, etc.) is used.- Places where there is much oil mist, e.g. metal working plants, kitchens, etc.- Places covered with heat insulating materials or combustibles.- Places where fixtures are buried in snow.●Do not disassemble or modify the fixture. It may cause fall of the fixture, electric shock or fire.●Do not remove the vent filter and give shock to the fixture to avoid water intrusion.●Use a designated waterproof junction box for connection to the power cable.●Do not operate the product when it is damaged.●If there are abnormalities found in the product such as smoke or unusual odor, disconnect power immediately and contact dealers.●Use the fixture within the specified input voltage range.	

**CAUTION**

Failure to comply with the following installation instructions may result in injury.

- This product is for general outdoor and indoor use only.
- The wind pressure resistance is 60m / s. Do not install in places where the wind speed exceeds it to avoid fall of the fixture.
- The product must be used with the specified input voltage and frequency.
- The product must be used at an ambient temperature of -20 ° C to 50 ° C. During the daytime, do not use it except for temporary operation check. Failure to comply with them may reduce the life of the fixture and cause electrical shock or fire.
- When the product is used in cold areas, do not install in places where icicles can fall.
- Do not install the product in places containing sulfur component such as hot spring.
- Do not install the product towards the sun. Concentrated sunlight may damage the LED and result in malfunction or fire.
- Do not install upward without the shade and the secondary lenses. Installing the fixture within $\pm 5^\circ$ from horizontal may cause internal condensation.

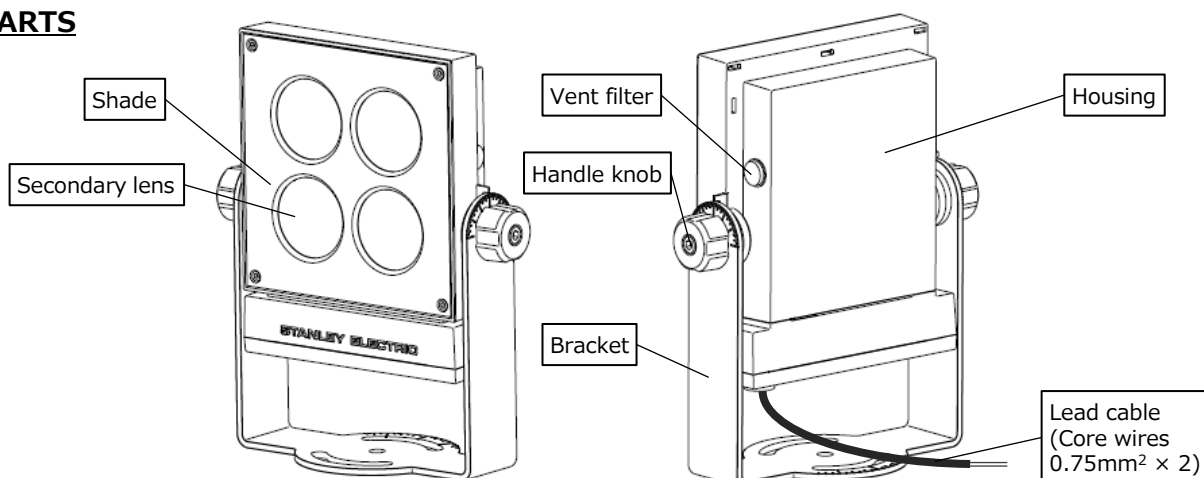
PARTS**INSTALLATION**

1. Install two M10 anchor bolts in the ground.

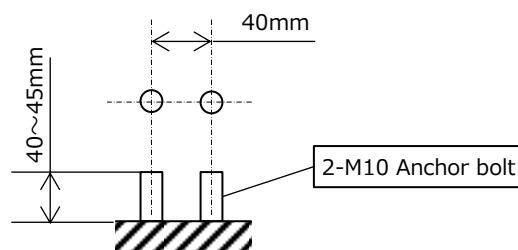

2. Secure the bracket to the anchor bolts using plain washers, spring lock washers and hexagon nuts.

Recommended torque : 24.5 N·m

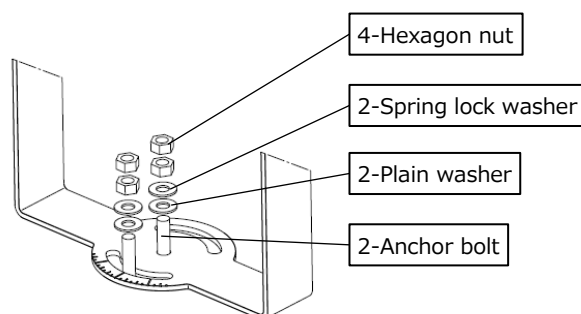

Electrical installation

- 1. Before installing, disconnect power to avoid electrical shock.
- 2. Cut the front end part of the lead cables coated with solder, and then peel off covering materials.

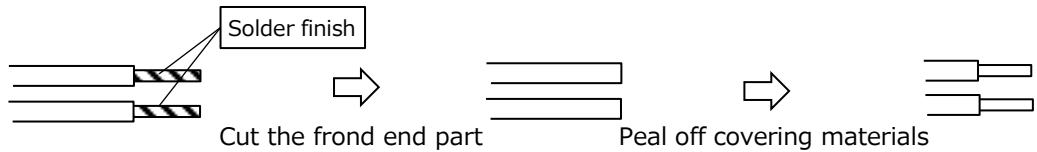

- 3. Connect the lead cables with power input.
Use waterproof junction boxes to avoid water entry, electrical shock and fire.

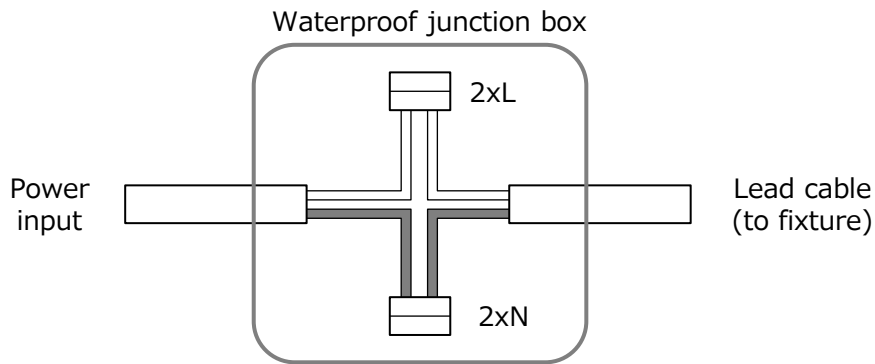

Adjustable beam orientation

- Loosen the right and left screws with the handle knobs, and then tilt the fixture while supporting it by hand.
 - Re-tighten the screws with the handle knobs.
- Ensure that the hexagon socket head bolts are tightened by a proper tool.

Recommended
torque : 6.2N•m

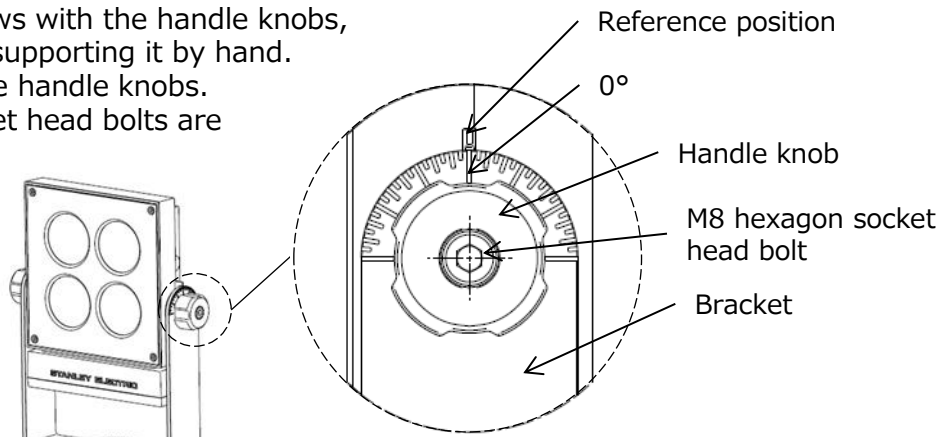

The brackets have graduations at intervals of 5°.

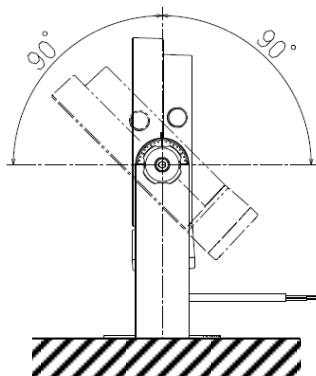

Adjustable vertical pivot limit

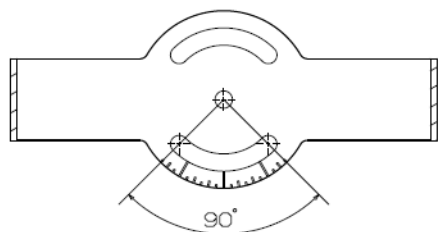

Adjustable horizontal pivot limit

Fall prevention wire

Attach the fall prevention wire to the strong construction material as shown below.

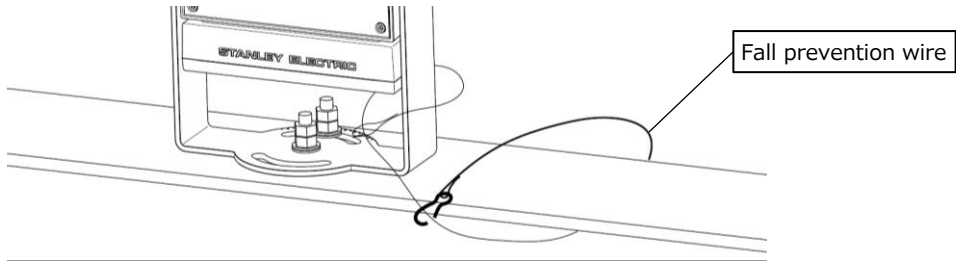

Accessories

Refer to each instruction manual for mounting the hood (LLF0112A / HOOD) and the louver (LLF0112A / LOUVER).

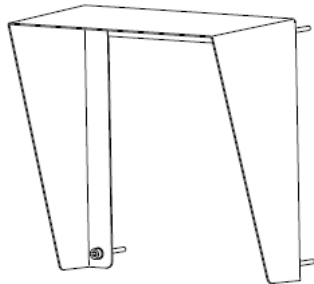

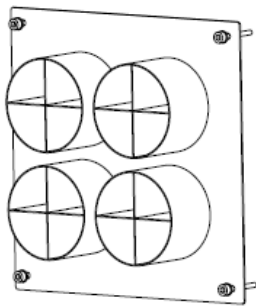

Hood
LLF0112A/HOOD



Louver
LLF0112A/LOUVER

Installation	Leave the instructions for users/customers for future reference.
--------------	--

 WARNING	Failure to comply with the following installation instructions may result in death or serious injury.
<ul style="list-style-type: none">• This product must be cleaned in accordance with the installation instructions to avoid fall of fixture, electrical shock or fire.• Turn off the power before cleaning the product.• Do not repair, disassemble, or modify the fixture.• Do not stare at the operating light source.	

 CAUTION	Failure to comply with the following installation instructions may result in injury.
<ul style="list-style-type: none">• Turn off the power and leave the fixture until it becomes ordinary temperature before cleaning to avoid a burn.• High ambient temperature can reduce the product life.• If there are abnormalities found in the product within the lifetime, disconnect the power immediately and contact your dealer. Using the product with abnormalities may cause fire or electrical shock.• When the product is used in a snowy area, remove the snow to prevent the product from being buried in snow.• Dirt on the fixture can reduce efficiency. It is recommended to clean the fixture by yourself once a year.• Conduct self-inspection at least once a year for safety.• Have the product inspected by experts at least once every three years. (A product used for more than three years requires a thorough inspection.) Using the product with abnormalities may cause smoking, fire, electric shock or fall of the fixture.• LED has dispersion in brightness and light color. The product may have different light color and brightness even among products with the same model number.• Please note that unevenness of the projected light may be noticeable depending on the irradiation distance or the condition of the irradiation surface.• Keep radios, TV or equipment with infrared remote-control systems away from the fixture.• Do not install in places where the product will undergo sudden cooling or heating, which may cause condensation inside the product.• Do not modify or add parts to make water gather around the vent filter.• Do not intentionally touch or remove the vent filter. It may impair waterproofness.	

Cleaning

- Turn off the power and leave the fixture until it becomes ordinary temperature before cleaning to avoid a burn.
- Clean the outer surface of the fixture or the cover with a soft cloth wetted with water or neutral detergent.
- Do not use volatile substances (e.g. thinner and benzine) or acid-alkaline detergent. Using such substances may cause discoloration or deformation.
- Do not spray water directly on the fixture with tools like a hose. Moreover, do not clean the fixture with a mop, a deck brush. They may cause water intrusion or damage to the fixture.

Warranty

- Immediately after delivery, conduct an acceptance inspection and judge whether it is acceptable or unacceptable.
If no special problems are raised, we will judge that quality confirmation has been conducted and the acceptance inspection has been passed.
- Check the warranty period described on the warranty card.
The warranty covers each single article delivered. It does not cover costs such as work fees and damage compensation incurred because of replacement work.
- The warranty does not cover failure caused by the following:
 - (1) Inadvertent handling and misuse
 - (2) Remodeling or repair by yourself
 - (3) Use under improper environment and conditions
 - (4) Natural disasters (fire, earthquake, and typhoon)
 - (5) Water condensation that occurs when the product is used out of the use and preservation temperature conditions specified in the specification sheet
 - (6) Electrical stress, such as excessive voltage surge, including lightning
- If the cause of the failure cannot be identified, negotiations shall be conducted between the two companies.
- The application of this product is intended as a lighting or light source.
We shall not assume any responsibility for any damage caused by use under an application not intended by us.

Exchange

- During the warranty period, contact the retailer (construction shop) where you purchased the product with an item that can specify the delivery date.
- If the warranty period has expired, consult your dealer (construction shop).
We will exchange it for a fee on request.
- If you have any questions about after-sales service or consult about replacement, please contact the retailer where you purchased the product (construction shop) or our sales office below. In that case, please let us know the product name and the time of purchase.

Contact

- Please contact us after confirming the product name on the nameplate.
- Phone number and address may change. Please confirm the website.

STANLEY ELECTRIC CO.,LTD.

Yokohama Technical Center: 2-14-1 Edanishi, Aoba-ku, Yokohama-shi, Kanagawa, 225-0014 Japan

TEL : +81 45 912 9222

URL: <http://www.stanley.co.jp/>

Headquarters: Nakameguro, Meguro-ku, Tokyo, 153-8636 Japan

TEL : +81 3 3710 2222