

LEDHIGHBAY

LED High Bay Lighting
LED Lighting under the Eaves

LLF0058A
LLF0040A

Remarkably thin and light

LED High Bay Lighting LLF0058A

Compact but powerful

LED Lighting under the Eaves LLF0040A

LEDSFOCUS
Landscape Lighting

LEDSROAD
Road Lighting

LEDHIGHMAST
Outdoor LED floodlight

LEDHIGHBAY
Indoor Maintenance-Free
Lighting

LEDHIGHBAY

LED Lighting under the Eaves LLF0040A

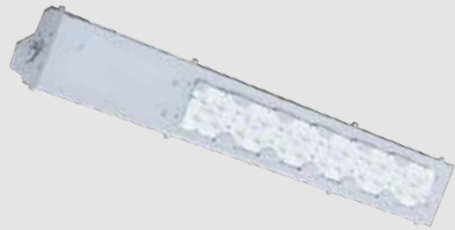

pdf data

Concept

The LED module used in this lighting is waterproof. With the light distribution control by lens, we materialized a light distribution that stretches along the long side of the product. The presence of the fixture can be hidden because the width of the product is small and thus it can be placed in the wiring duct.

Features



Compact

Designed to be as compact as the external dimension 650 x 100 x 153mm (incl. arm).

Angle adjustment

The arm allows adjustment of the irradiation angle.

Wide variety of lenses

The optical lenses enable a wide range of lighting designs.

Moisture-proof and rainproof

It has IP23.

Projects



Sapporo Ryutsu System, Sapporo Hokkaido



Sapporo Ryutsu System, Nagoya Aichi



Lights inside the factory of Indonesia Stanley, Indonesia

Product Image



Front



Side



Back

External Dimensions

unit: mm

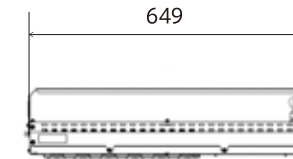
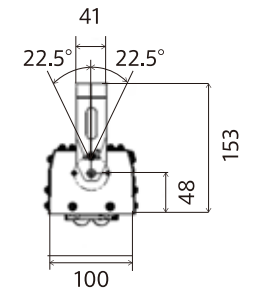
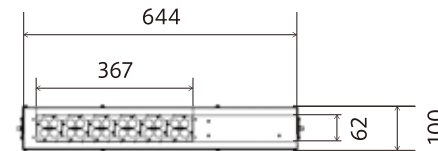

Specifications

Part No.

LLF0040A

Color Temperature:	5000K
Power Consumption:	52W (at AC 220V)
Light source luminous flux:	5,760 lm (5000K)
Luminous Efficiency:	111 lm/W
Material:	SECC
Color Rendering Property:	Ra70
Input Voltage:	AC90 ~ 305V/rated voltage AC100 ~ 277V

Ambient Temperature:	-20 ~ 50°C
Waterproof and dustproof:	IP23
Variation of Lens:	narrow angle/medium angle/wide angle
Weight:	3.7kg
Power Source:	Built-in
Lightning Surge Protection Pressure Resistance:	10kV (Common mode)
LED light source lifetime:	40,000h (lumen maintenance factor 70%)