

Landscape Lighting

LED Floodlight with Ultra Narrow Light Angle (Gold)

LLM0545A-UB



Perfectly unique gold

*Gold light that has been created by phosphor of Stanley's original composition technology

Eiffel Tower Special Light-up, Paris, France
Organization: The Japan Foundation

Executive Committee for Special Light-up of Eiffel Tower, Japonismes 2018

Cooperation in Development: Motoko Ishii Lighting Design Inc.

Planners and Producers: Motoko Ishii and Akari-Lisa Ishii

Lighting Design & Production: Motoko Ishii & Motoko Ishii Lighting Design Inc. (Tokyo) and Akari-Lisa Ishii & I.C.O.N. (Paris)

Examples



LED Floodlight with Ultra Narrow Light Angle(Gold)

LLM0545A-UB



Features

- Color of light: Materialized the color of light which emphasizes gold color.
- Ultra narrow light angle: Materialized the narrow-angle and oval light distribution whose 1/2 beam angle is 4° x 3°.
- Thin and lightweight: With 47mm thickness (light source part) and 2.3kg (bracket excluded), it can be installed at any place.
- Low power consumption: Power consumption is as low as 39.4W.
- Water and dust resistance: Available for outdoor usage with IP65.

Design Concept

The first gold LED floodlight has been created, being applied our technologies for white LED in development. When irradiating gold-colored objects such as temples or Buddha statues, it can emphasize the object's gold color a lot more strongly than a floodlight with white light does. It can also color non-gold objects gold with its light.

Accurate irradiation of gold light toward the object



Eiffel Tower Special Light-up, Paris, France

Organization: The Japan Foundation
Executive Committee for Special Light-up of Eiffel Tower, Japonismes 2018
Cooperation in Development: Motoko Ishii Lighting Design Inc.
Planners and Producers: Motoko Ishii and Akari-Lisa Ishii
Lighting Design & Production: Motoko Ishii & Motoko Ishii Lighting Design Inc. (Tokyo) and Akari-Lisa Ishii & I.C.O.N. (Paris)



The phoenix and the Amitabha statue in Byodo-in, Kyoto



Patuxai, Vientiane, Laos



Product Image



Front



Side



Back



Bracket with angle adjustment structure (sold separately)

External Dimension

unit: mm

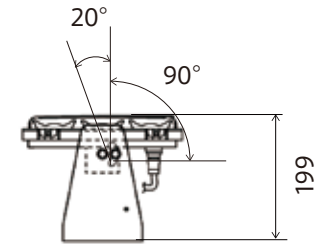
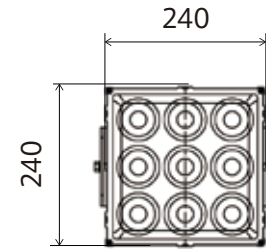

Bracket with angle adjustment structure (sold separately)

Specifications

Part No.	LLM0545A-UB
Center Luminosity (cd):	667,000
Luminous Flux (lm):	3,300
1/2 Beam Angle:	4° × 3°
Material:	Body: aluminum die-cast, Outer lens: polycarbonate Bracket (sold separately): stainless
Rated Power Consumption: (excl. power source)	39.4W
Maximum Power Consumption: (excl. power source)	45.7W
Ambient Temperature:	-30 ~ +50°C
Water and Dust Resistance:	IP65
Life of LED's Light Source:	40,000h (lumen maintenance factor 70%)
Power Source:	Placed separately (sold separately)
Weight:	2.3kg
Optional Parts:	Power Source, bracket, 10m cable

Projection Area

